



# FORUM CORINTHIA HANG MOUNT LINEAR

JOB \_\_\_\_\_

TYPE \_\_\_\_\_

**DESCRIPTION:** The FORUM/CORINTHIA HANG MOUNT LINEAR fixture provides an indirect general illumination where quality lighting is required to meet specific tasks.

**APPLICATIONS:** Classrooms, Office Areas, Libraries, Lobbies, Retail Stores, Design Centers and Corridors.

**MOUNTING HEIGHTS:** The top of the fixture to ceiling should be a minimum of 18" for all fixtures (see mounting sheet for detail information).

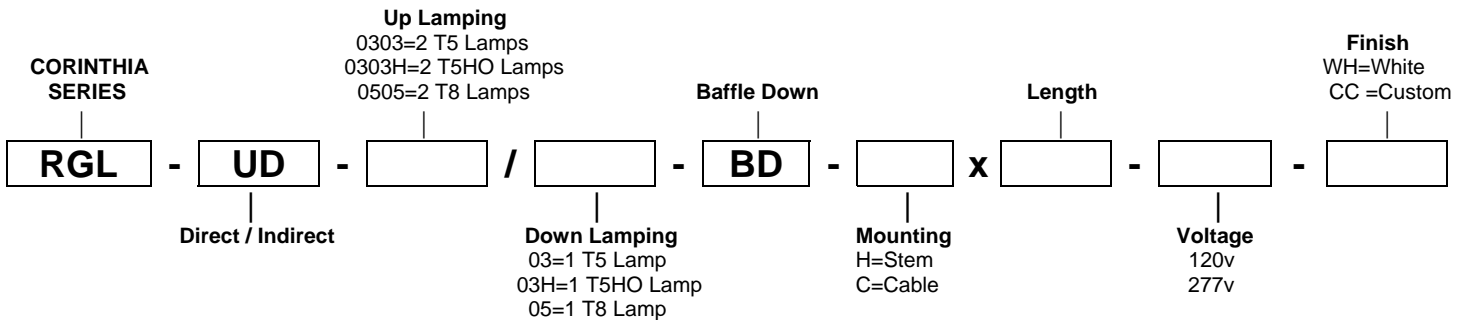
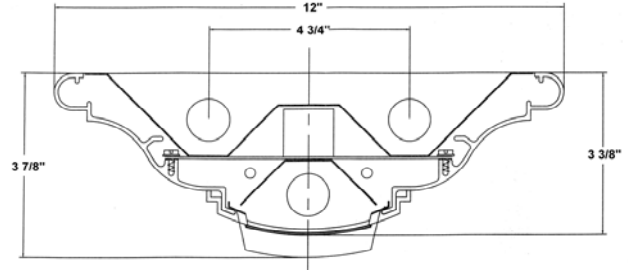

**SPECIFICATIONS:**

The FORUM/CORINTHIA HANG MOUNT LINEAR housing shall be a nominal 3 3/4" high x 12" wide consisting of heavy gauge aluminum extrusion 6063-T5 alloy (.090" minimum wall thickness). Sockets shall be prewired and factory installed. The ends shall be .250" thick aluminum with no visible fasteners. Standard continuous single sections shall be 16 feet. Standard finish shall be white consisting of a high solids baked polyester paint pretreated with a five (5) stage cleaning/conversion coating rust inhibitor. Other painted architectural finishes available as well as satin anodized.

**REFLECTOR:** Reflector shall be die formed 22 gauge aluminum with 86% reflectivity.

**BALLAST:** Ballast shall be energy saving CBM/ETL certified Class P. For electronic ballast add EL to catalog number.

**PRODUCT LISTING:** Shall be U.L. listed.