



# FORUM FORM

JOB \_\_\_\_\_

TYPE \_\_\_\_\_

**APPLICATIONS:** Conference rooms, corridors, waiting rooms, and over tables and mirrors.

**MOUNTING HEIGHT:** Top of fascia should be at least 72 inches above the floor and not less than 10 inches below the ceiling.

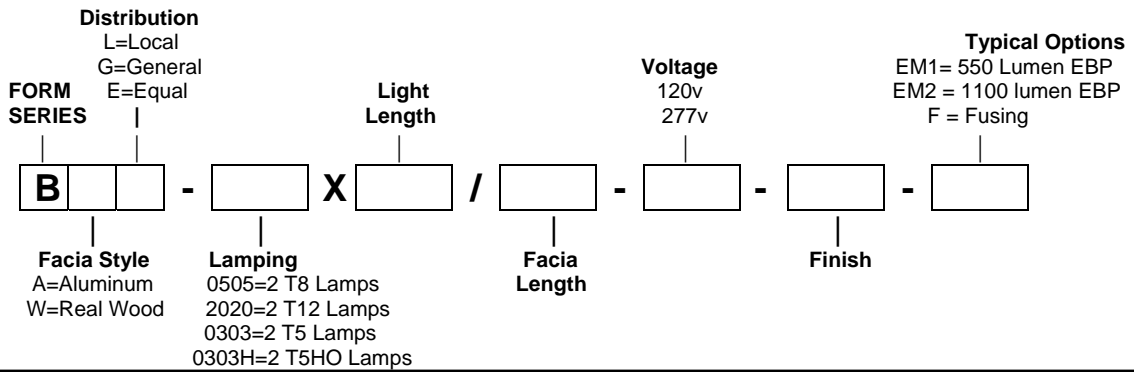
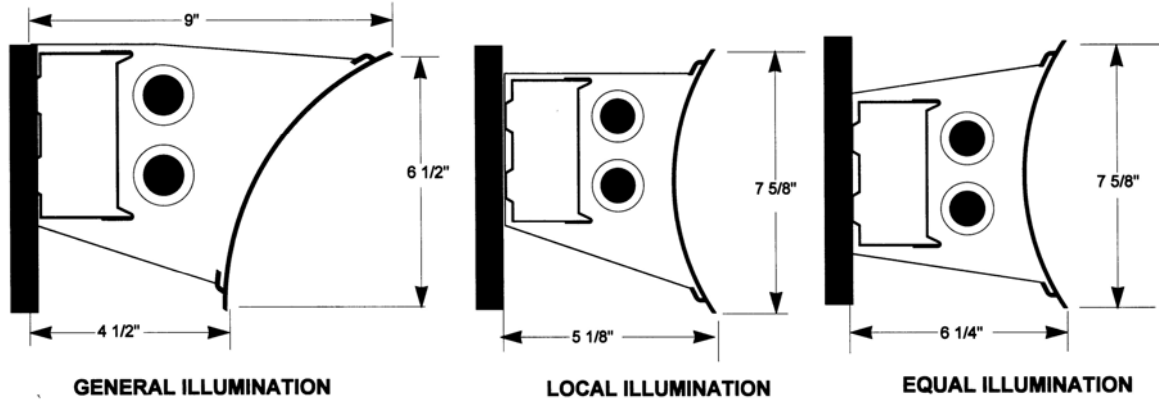

**SPECIFICATIONS:**

**FIXTURE AND HARDWARE:** All metal components are finished with baked enamel, minimum 89% reflectance. Fixtures and reflectors are constructed from 20 gauge steel, fascia supports are of 18 gauge steel. Fixture reflectors are contoured for optimum reflectivity and brightness control. Sockets are prewired and mounted on 18 gauge metal brackets. When assembled no unnecessary fasteners, tabs or knockouts are visible.

**FACIA:** Extruded aluminum fascia is curved to provide evenly distributed optimum light. The inside (or back) of the fascia is finished in an 89% (minimum reflectance white enamel. The thickness of the extruded aluminum fascia shall be .109". The exterior fascia finish shall be available in either painted or real wood veneer treatment.

**WEATHERPROOF FIXTURES:** The fixture is suitable for damp, weather protected areas.

**BALLAST:** Standard ballast shall be electronic type CBM/ETL certified "Class P".

**PRODUCT LISTING:** The fixture shall be U.L. listed.



# FORUM FORM

JOB \_\_\_\_\_

TYPE \_\_\_\_\_

**APPLICATIONS:** Conference rooms, corridors, waiting rooms, and over tables and mirrors.  
**MOUNTING HEIGHT:** Top of fascia should be at least 72 inches above the floor and not less than 10 inches below the ceiling.

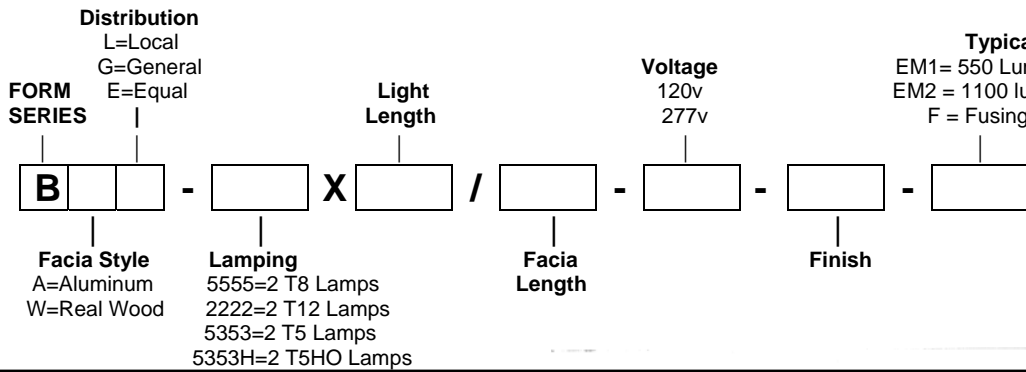
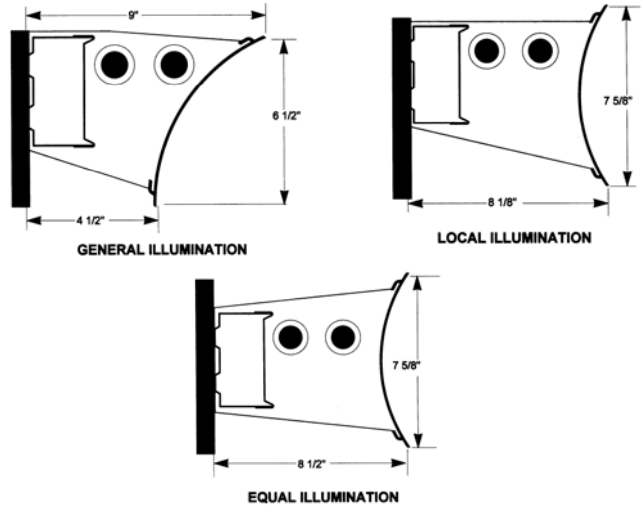

**SPECIFICATIONS:**

**FIXTURE AND HARDWARE:** All metal components are finished with baked enamel, minimum 89% reflectance. Fixtures and reflectors are constructed from 20 gauge steel, facia supports are of 18 gauge steel. Fixture reflectors are contoured for optimum reflectivity and brightness control. Sockets are prewired and mounted on 18 gauge metal brackets. When assembled no unnecessary fasteners, tabs or knockouts are visible.

**FACIA:** Extruded aluminum facia is curved to provide evenly distributed optimum light. The inside (or back) of the facia is finished in an 89% (minimum) reflectance white enamel. The thickness of the extruded aluminum facia shall be .109".

The exterior facia finish shall be available in either painted or real wood veneer treatment.

**WEATHERPROOF FIXTURES:** The fixture is suitable for damp, weather protected areas.

**BALLAST:** Standard ballast shall be energy saving type CBM/ETL certified "Class P".

**PRODUCT LISTING:** The fixture shall be U.L. listed.

**ENVIRONMENTAL RESEARCH LABORATORIES**

7419 E. HELM DRIVE, THUNDERBIRD INDUSTRIAL AIRPARK, SCOTTSDALE, ARIZONA 85260 TELEPHONE: (602) 948-3471  
 CERTIFIED TEST REPORT NO. ERL 2101

FORUM VALENCE LUMINAIRE, CAT. NO. G2222 X 4/4  
 HORIZONTAL LAMPS  
 TWO F40T12CW FLUORESCENT LAMPS, RATED 3200 LUMENS EACH

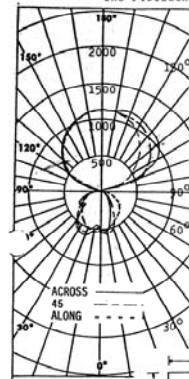

**CANDLEPOWER SUMMARY**

ANGLE	ACROSS	67.5	45	22.5	ALONG	OUTPUT LUMEN
0	510	510	510	510	510	
5	598	594	579	550	507	53
10	552	577	624	588	511	
15	423	452	532	595	492	145
20	316	352	440	580	482	
25	224	250	345	508	458	168
30	147	177	253	434	430	
35	89	115	200	367	407	145
40	34	56	131	293	370	
45	2	11	75	222	328	96
50	1	1	30	170	293	
55	2	2	5	126	254	59
60	0	0	1	72	211	
65	0	0	2	29	170	29
70	0	0	0	3	117	
75	0	0	0	0	80	11
80	0	0	0	0	41	
85	0	0	0	0	12	2
90	0	0	0	0	0	

**ZONAL LUMENS AND PERCENTAGES**

ZONE	LUMENS	% LAMP	% FIXTURE
0-30	401	6.27	8.23
0-40	628	9.82	12.90
0-60	980	15.32	20.12
0-90	1245	19.45	25.36
40-90	616	9.64	12.66
60-90	264	4.14	5.44
90-180	3626	56.67	74.44
0-180	4871	76.12	100.00

\*\* EFFICIENCY = 76.12% \*\*

PREPARED FOR:  
 FORUM INC.,  
 PITTSBURGH, PA.

**LUMINANCE SUMMARY - FOOTLAMBERTS**

ANGLE	ACROSS		ALONG	
	AVG	MAX	AVG	MAX
45	NOT	NOT	921	3362
55	SIGNIFICANT	878	3113	3.5
65	0	0	799	3001
75	0	0	611	2503
85	0	0	279	285

CERTIFIED BY: *Tom Levin*

DATE: JAN 21, 1977

TESTED IN ACCORDANCE WITH IES PROCEDURES. TEST DISTANCE EXCEEDS 25 FEET.



**THREE-LAMP FLUORESCENT FIXTURE  
265 MA T-8 AND 430 MA T-12**

**APPLICATIONS:** Conference rooms, corridors, waiting rooms, and over tables and mirrors.

**MOUNTING HEIGHT:** Top of fascia should be at least 72 inches above the floor and not less than 10 inches below the ceiling.

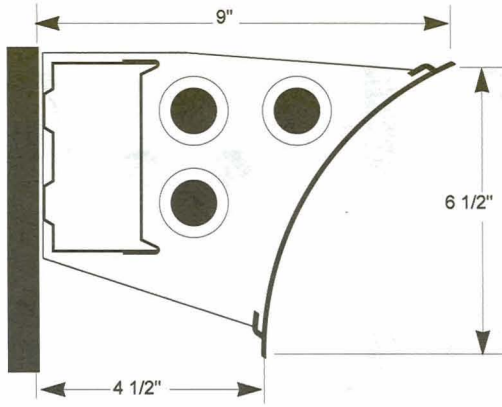

**GENERAL ILLUMINATION**

- \* BAG or BWG-1515 (265 MA)
- BAG or BWG-2323 (430 MA)

\* A = Painted Aluminum  
W = Wood Veneer

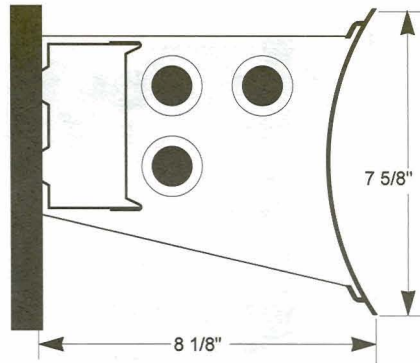

**LOCAL ILLUMINATION**

- BAL or BWL-1515 (265 MA)
- BAL or BWL-2323 (430 MA)

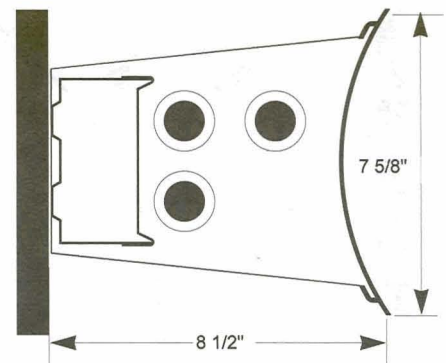

**EQUAL ILLUMINATION**

- BAE or BWE-1515 (265 MA)
- BAE or BWE-2323 (430 MA)

LIGHT LENGTH (FT)	CHANNEL LAYOUT (FT)	PRE-CUT FACIA LENGTH	FIELD-CUT FACIA LENGTH (FT)	FACIA OVERHANG EACH END (IN.)	INPUT WATTS 265 MA T-8	INPUT WATTS 430 MA T-12
2	2	2'-2"	3	6	62	69
3	3	3'-2"	4	6	87	124
4	4	4'-2"	6	12	107	144
6	6	6'-2"	8	12	174	228
8	8	8'-2"	12	24	210	276
12	8-4	12'-2"			317	420
12	6-6		16	24	348	456
16	8-8	16'-2"	20	24	420	552
18	6-6-6	18'-2"	22	24	522	684
20	8-4-8	20'-2"	24	24	527	696
22	8-6-8	22'-2"	26	24	594	780
24	8-8-8	24'-2"	28	24	630	828
28	8-8-4-8	28'-2"	32	24	737	972
32	4-8-8-8-4	32'-2"			844	1116
32	8-8-8-8		36	24	840	1104
36	4-8-8-8-8	36'-2"	40	24	947	1248
40	8-8-8-8-8	40'-2"	44	24	1050	1380
44	4-8-8-4-8-8-4	44'-2"	48	24	1161	1536
48	8-8-8-8-8-8	48'-2"			1260	1656
48	4-8-8-8-8-8-4		52	24	1264	1668

**SPECIFICATIONS:**

**FIXTURE AND HARDWARE:** All metal components are finished with baked enamel, minimum 89% reflectance. Fixtures and reflectors are constructed from 20 gauge steel, fascia supports are of 18 gauge steel. Fixture reflectors are contoured for optimum reflectivity and brightness control. Sockets are prewired and mounted on 18 gauge metal brackets. When assembled no unnecessary fasteners, tabs or knockouts are visible.

**FACIA:** Extruded aluminum fascia is curved to provide evenly distributed optimum light. The inside (or back) of the fascia is finished in an 89% (minimum) reflectance white enamel. The thickness of the extruded aluminum fascia shall be .109".

The exterior fascia finish shall be available in either painted or real wood veneer treatment.

**WEATHERPROOF FIXTURES:** The fixture is suitable for damp, weather protected areas.

**BALLAST:** Standard ballast shall be energy saving type CBM/ETL certified "Class P".

**PRODUCT LISTING:** The fixture shall be U.L. listed.



# FORUM

## FORM & LINE SERIES

MOUNTINGS / ACCESSORIES  
AND HOW TO SPECIFY

B=FORUM/FORM  
(CURVED FACIA)  
L=FORUM/LINE  
(FLAT FACIA)

A=PAINTED ALUMINUM  
W=REAL WOOD

VOLTAGE  
120V or 277V

### BAL - 2020 X 8/8 - 120V - FINISH

DISTRIBUTION  
L=LOCAL  
G=GENERAL  
E=EQUAL

LAMP COMBINATION  
SEE CATALOG PGS  
44 & 45

INDICATES FACIA LENGTH  
INDICATES LIGHT LENGTH

WHITE STANDARD FOR  
ALUMINUM FACIA. SEE  
CATALOG PAGE 68 FOR  
REAL WOOD FINISH  
SELECTION

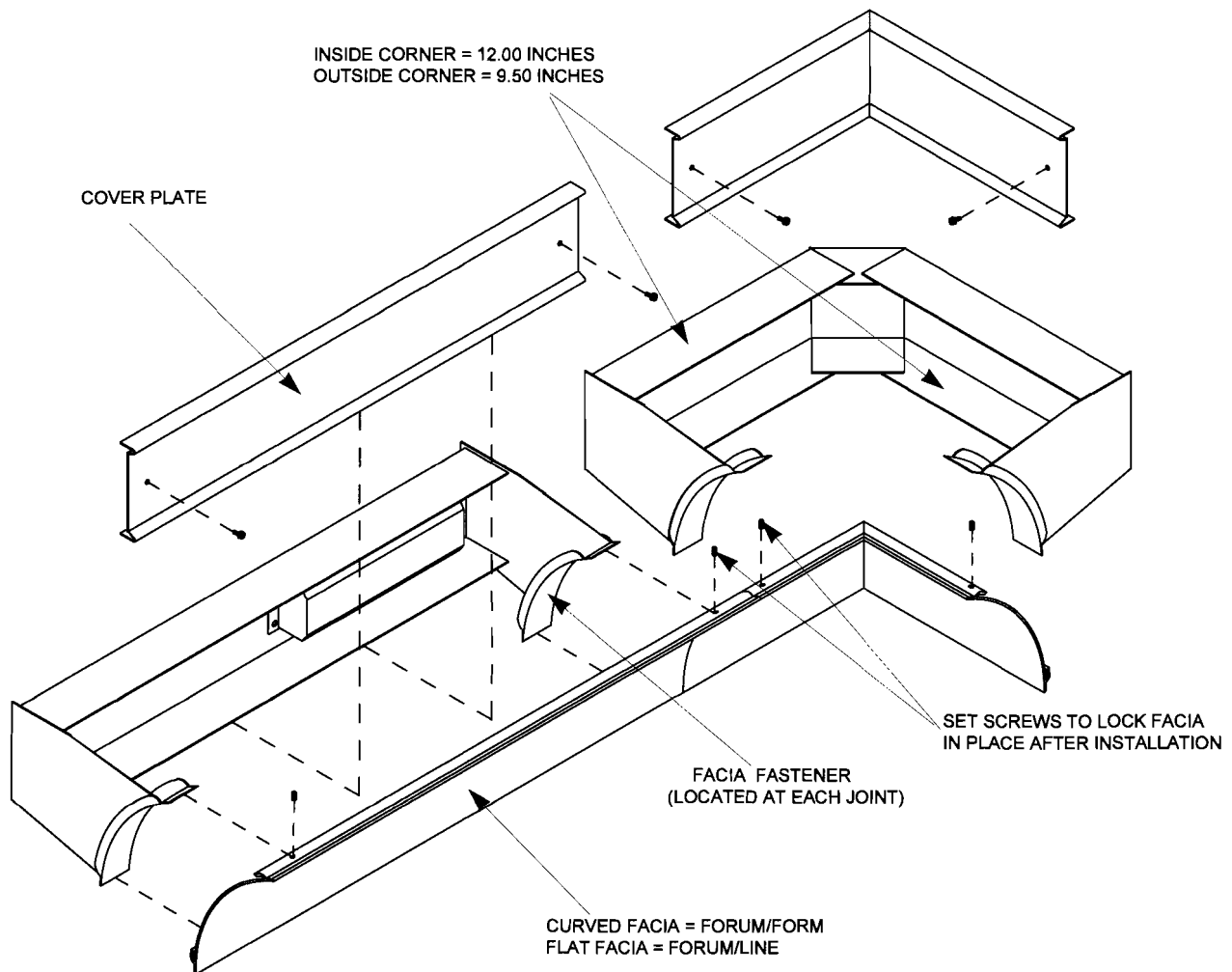

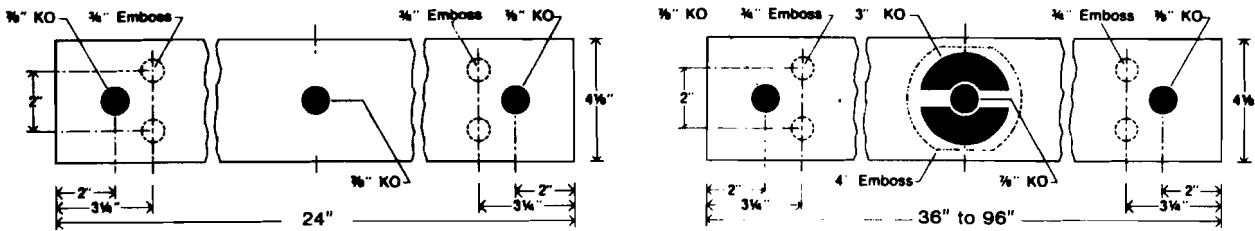

**Standard knockout patterns**

**How to specify**

Use the Forum/Form numbering system to specify

**Step 1:**

Specify either BAG-2222 or BWG-2222 (A for aluminum-finish facia, W for wood-veneer facia).

**Step 2:**

Using the table below, specify the length of channel and length of facia required.

You can specify lengths of facia either "pre-cut" or "field-cut."

All pre-cut facia lengths are 2 inches longer than the channel length (example: BAG-2222 x 8/8 specifies this fixture with 8'-0" channel and 8'-10" facia).

Field-cut facia lengths should be specified when you wish to run facia the full length of a wall but the wall measures more than the channel and less than the next avail-

able pre-cut length. (Example: if a wall measures 11 feet 7 inches, specify BAG-2222 x 8/12 and trim 5 inches off the facia).

**Step 3:**

From the Color Selector Sheet, select one of the several architectural aluminum finishes or wood-veneer finishes and specify by name, e.g. "walnut".

The table below also gives power requirements and number of lamps required.

Pre-Cut Lengths		Field-Cut Lengths		Facia Overhang Each End	Input watts per run	Lamps required		
Select Length of Light (ft.)	Channel Layout	Length of Fixture & Facia	Facia Layout				Length of Fixture & Facia	Facia Layout
2*	2	X2/2	2	X2/3	3	1/2 foot	43	2-F20
S-2*	2	X2/2	2	X2/3	3	1/2 foot	52	2-F20
3*	3	X3/3	3	X3/4	4	1/2 foot	76	2-F30
S-3*	3	X3/3	3	X3/4	4	1/2 foot	96	2-F30
4**	4	X4/4	4	X4/6	6	1 foot	92	2-F40
S-4**	4	X4/4	4	X4/6	6	1 foot	104	2-F40
6	6	X6/6	6	X6/8	8	1 foot	152	4-F30
8	8	X8/8	8	X8/12	12	2 feet	184	4-F40
12	8-4	X12/12	12				276	6-F40
12	6-6			X12/16	8-8	2 feet	304	8-F30
16	8-8	X16/16	8-8	X16/20	10-10	2 feet	368	8-F40
18	6-6-6	X18/18	9-9	X18/22	11-11	2 feet	456	12-F30
20	8-4-8	X20/20	10-10	X20/24	12-12	2 feet	460	10-F40
22	8-6-8	X22/22	11-11	X22/26	10- 6-10	2 feet	520	4-F30 8-F40
24	8-8-8	X24/24	12-12	X24/28	10- 8-10	2 feet	552	12-F40
28	8-8-4-8	X28/28	8-12-8	X28/32	10-12-10	2 feet	644	14-F40
32	4-8-8-8-4	X32/32	12- 8-12				736	16-F40
32	8-8-8-8			X32/36	10- 8- 8-10	2 feet	736	16-F40
36	4-8-8-8-8	X36/36	12-12-12	X36/40	10-10-10-10	2 feet	828	18-F40
40	8-8-8-8-8	X40/40	8-12-12-8	X40/44	10-12-12-10	2 feet	920	20-F40
44	4-8-8-4-8-8-4	X44/44	12-10-10-12	X44/48	6-12-12-12-6	2 feet	1012	22-F40
48	8-8-8-8-8-8	X48/48	12-12-12-12				1104	24-F40
48	4-8-8-8-8-8-4			X48/52	10-12- 8-12-10	2 feet	1104	24-F40

NOTE: On pre-cut lengths, facia overhangs one inch on each end of total length, i.e.: 48' length, the delivered length of facia would be 48' 2". For lengths exceeding 48', add nearest other length or combination of lengths to arrive at length required.

(s) Separate ballasts for two-circuit wiring.

\*Not Available for types 30, 40, 50, 6060, and 7070.

\*\*Not Available for types 40, 50, and 7070.

**SPECIFICATIONS**

**Fixture and Hardware:** All metal components are finished with baked, minimum 89% reflectance, white enamel on rust inhibiting steel. Fixtures and reflectors are constructed of 20-gauge steel, facia supports are of 18-gauge steel. Fixture reflectors are contoured for optimum reflectivity and brightness control. Sockets are prewired and mounted on 18-gauge metal brackets. When assembled, no unnecessary fasteners, tabs, or knockouts are visible.

**Facia:** Extruded aluminum facia is curved to provide evenly distributed optimum light. The inside (or back) of the facia is finished in an 89% (minimum) reflectance white enamel. The thickness of the extruded aluminum facia is .109 inch. The outside (or front) of the facia is available as either:

1. extruded aluminum facia in architectural finishes.
2. real-wood veneer laminated to the extruded aluminum facia.

The extruded aluminum facia is available in a selection of architectural finishes and the real-wood finish is available in a variety of wood veneers. All wood veneers are also available in "butcher block" patterns. Refer to finish sample page in catalog. Special architectural aluminum finishes or wood veneers can be supplied. Please contact the factory or your Forum representative.

**Weatherproof Fixtures:** This fixture is available for damp but weather protected areas and for areas where corrosive gases may be prevalent. Please add initials WP after the first three letters

of the Forum/Form code word.

**Accessories** (see accessory guide):

**Corners** (see corner layout guide):

**Ballasts:** Standard ballasts used are 120-volt CBM/ETL certified. "Class P".

Note: All 20-watt ballasts will be HPF unless otherwise specified. Dimming ballasts and systems are available. Please contact the factory or your Forum representative.

Note: Separate Switching: When separate lighting circuits are desired, specify an "S" (separate switching) after the catalog No., e.g. 1515S, 2525S, 3535S. U.L. Approved.

Project \_\_\_\_\_

Electrical Engineer \_\_\_\_\_

**Forum, Inc.**  
450 Butler Street  
Pittsburgh, Pa. 15223  
Phone: (412) 781-1989

Forum/Form 16



Flat Cut Red Oak



Rift Red Oak

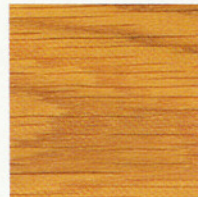

Flat Cut White Oak



Rift White Oak



Flat Cut Teak



Flat Cut Ash



Flat Cut Walnut



Flat Cut Cherry

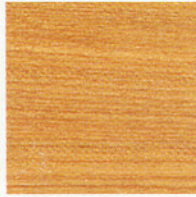

Flat Cut Red Birch

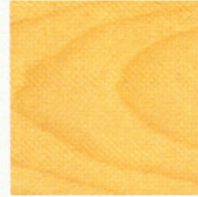

Flat Cut White Birch



Plain Maple



Plain Pecan



South American Rosewood

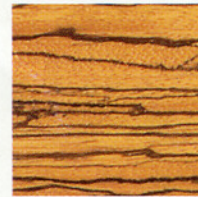

Zebra

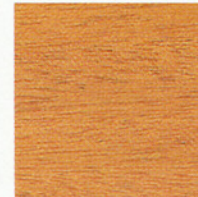

Flat Cut African Mahogany



Carpathian Burl

If the wood desired is not shown, please contact the factory or your Forum representative.

Forum offers an unlimited selection of custom finishes. To assure the correct color match, simply submit a color chip or the paint manufacturers name and color number. Chrome and Brass anodized finishes are also available.