

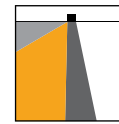

JOB _____

FIXTURE TYPE _____



SMALL BODY QUASAR
 AIM-ABLE ASYMMETRIC HID
 RECESSED CEILING MOUNT
 INDOOR USE

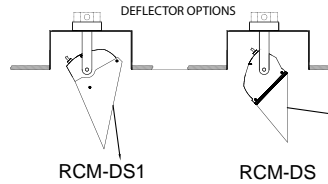
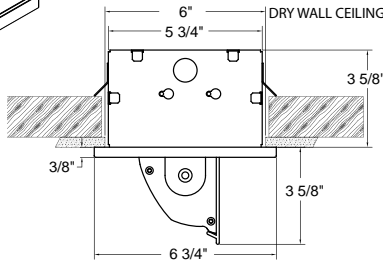
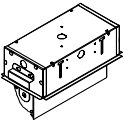
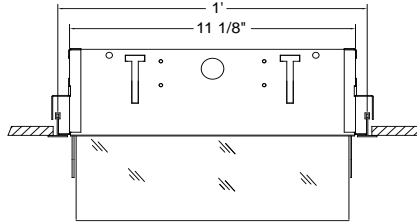
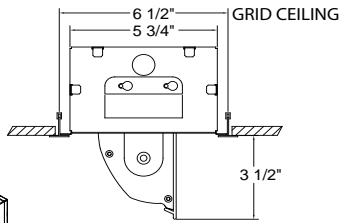

ORDERING CODE

Quasar **Housing:** **Lamp Qty:** **Lamping*:** **Style:** **Voltage:** **Finish:** **Optics REF/LENS:** **Options:**
Asymmetric **S = Small** **1 = Single** **39CMH = T6CMH** **1RCM = Recessed** **120 = 120 V** **WH = White (Standard)** **SA = Satin Anodized** **G = Grid Ceiling**
Adjustable **Body** **Lamp** **70CMH = T6CMH** **Cieling** **277 = 277 V** **CC = Custom Color** **SP = Specular** **D = Dry Wall Ceiling**
Aluminum **Only** **150CMH = T6CMH** **Mount** **AZ = Anodized** **Aluminum** **DS = Front Deflector**
HID Point **Source** **Only** **Only** **Only** **Only** **Only** **Hammtone** **DS1 = Rear Deflector**
Only **Only** **Only** **Only** **Only** **Only** **/FG = Frosted Micro** **PDS = Front Perf Deflector**
Only **Only** **Only** **Only** **Only** **Only** **Prism Glass** **PDS1 = Rear Perf Deflector**
Only **Only** **Only** **Only** **Only** **Only** **(Standard)** **EM-Q = Quartz Restrike**
Only **Only** **Only** **Only** **Only** **Only** **/CG = Clear Glass** **EM-S = Quartz Socket**
Only **Only** **Only** **Only** **Only** **Only** **/SG = Solite Micro** **DIM = Dimming****
Only **Only** **Only** **Only** **Only** **Only** **Prism Glass** **NAT = Natatorium**
Only **Only** **Only** **Only** **Only** **Only** **Only** **F = Fusing**
Only **Only** **Only** **Only** **Only** **Only** **Only** **MOD = Custom Modification***

QUA - S - 1 - [] - 1RCM - [] - [] - [] - []

* Consult Factory
 ** Specify Manufacturer

SPECIFICATION

FIXTURE BODY: Shall be .125" thick extruded 6063 -T5 aluminum with external surface ribbing for improved heat dissipation which will prolong lamp life. The standard finish for the housing is white. The end plates shall be .375" thick aluminum, gasketed and mechanically attached to the housing. The ends shall be painted white (standard).

LENS AND FRAME: Damp location fixture utilizes a mitered extruded aluminum frame that is gasketed and secured to the housing by four (4) captive screws, with a 0.125" thick high temperature frosted patterned tempered glass (standard).

REFLECTOR: Shall be bright dip anodized multifaceted pre-focused aluminum (standard).

BALLAST HOUSING: Shall be fabricated from 20 gauge galvanized steel.

DEFLECTOR SHIELDS: Shall be fabricated from 18 gauge steel. The shields shall be die formed, welded, and ground smooth to provide a seamless finished appearance. Standard finish shall be white powder coat to match housing. Custom finishes available.

RECESSED CEILING HOUSING: Shall be die formed from 20 gauge C.R.S.. Standard finish is white to match the housing.

PRODUCT LISTING: Shall be U.L. for damp location. All product manufactured in an IBEW union facility

PERFORMANCE

IES INDOOR REPORT BALL No. 14453.0
 PHOTOMETRIC FILENAME : QUA-S-150CMH.IES
 LAMP: M102 CDM150/T6G12/830, SPECULAR REFLECTOR, MICRO-PRISM LENS

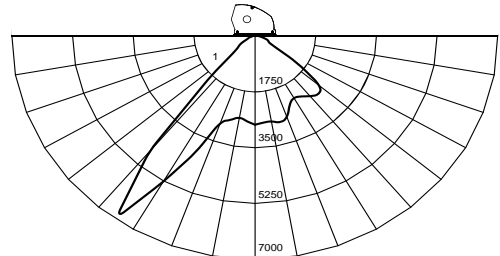

Maximum Candela = 6896 Located At Horizontal Angle = 157.5, Vertical Angle = 145
 # 1 - Vertical Plane Through Horizontal Angles (22.5-157.5) (Through Max. Cd.)

		Zonal Lumen Summary								
		Zone	Lumens	%Lamp	%Fixt					
	0	0	0	0	0	0	0	0	0	0
10	128	139	153	126	115	101	87	80	79	
20	391	392	331	891	695	264	227	163	146	
30	473	488	1501	1354	1205	2592	453	439	400	
40	2201	2461	2259	1571	1505	3659	2162	658	657	
50	2617	2454	2106	1816	2063	2344	6223	4648	3491	
60	2226	2195	2286	2416	2407	2404	4028	5223	6336	
70	2642	2704	2825	2652	2671	2511	2754	2805	2868	
80	2692	2679	2684	2727	2761	2689	2584	2546	2566	
90	2752	2752	2752	2752	2752	2752	2752	2752	2752	
							Total Luminaire Efficiency = 63.5%			